

ARTICLE III, SUBSECTION B, DEFINITIONS NO. 71,75,79,80

EXAMPLE OF LOT TYPES

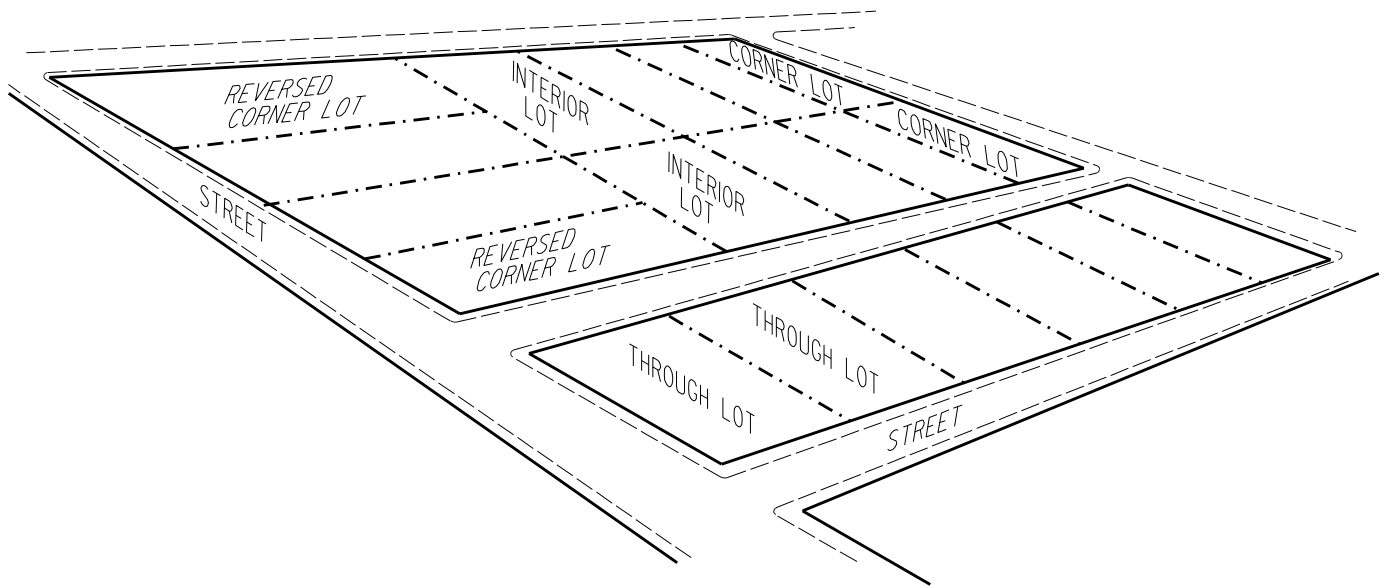
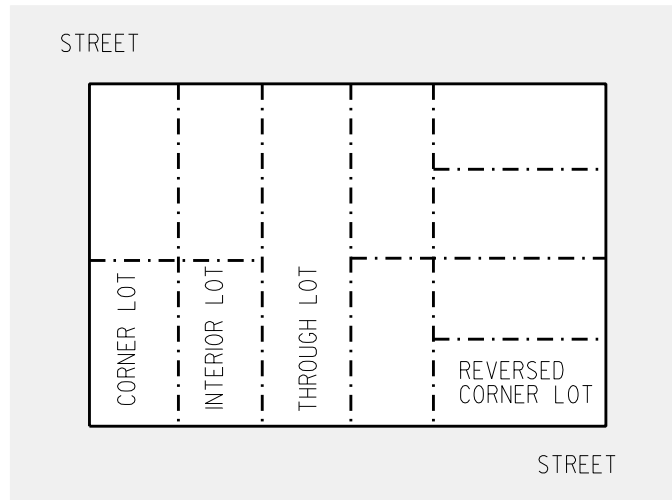

DEFINITIONS

- CORNER LOT** is a lot abutting on two streets at their intersection, where the angle of intersection is not more than 135 degrees.
- REVERSED CORNER LOT** is a corner lot the street side lot line of which is substantially a continuation of the front lot line of the first lot to its rear.
- INTERIOR LOT** is a lot other than a corner or reversed corner lot.
- THROUGH LOT** is a lot having a pair of opposite lot lines along two more or less parallel public streets. On a through lot both street lines shall be deemed front lot lines.